

BIKE TOURS OF CAMBRIDGE 2007

Sponsored by Cambridge Bicycle Committee
RIDE INFO: www.cambridgebikes.org



Sunday,
September 30
10:15 a.m. Start
Cambridge Common

Spread across the 6.2 square miles of Cambridge are 492 acres of public parks, playgrounds and reservations. These open spaces are essential to making the city livable by providing active and passive recreation space for kids and adults alike. Cambridge currently has 94 parks and play areas. These parks vary in size from one tenth acre to over 100 acres and include tot lots, neighborhood parks, school parks, community parks, large urban parks, natural resource parks and park trails. The Cambridge parks and playgrounds make up approximately 11% of Cambridge's total land area.



ride length: 13.5 miles
ride time: approx. 2.5 hours

Many of Cambridge's Parks and Playgrounds include a public art component. The 1979 Cambridge Public Art Ordinance mandates 1% of capital expenditures be committed to incorporation of art into new projects. The Public Art Program's goal from the beginning has been to respond to the City's diverse communities, with most of the art works created in active response to the character and history of their particular places.

The Parks and Playgrounds Bike Tour route includes many of the most recently renovated parks, such as Alden Playground on Oxford St (2006), Russell Field (2006), Franklin Street Park (2003), Cambridgeport's Dana Park (2004), Squirrel Brand Park (2004) and Gold Star Mothers Park on Gore Street (2006). The tour also pass by several parks in the process of renovation including the Father Callanan Playground at the Tobin School and the Harvard Street Park in Area 4.



TAYLOR SQUARE

Taylor Square is a new public artwork installed in front of the renovated Engine 8, Ladder 4 fire station in northwest Cambridge, at the intersection of Huron Avenue, Sherman Street, and Garden Street. Taylor measures only 57 square feet, and has a locked gate. It is a communal space through the distribution of 5,000 artist-designed keys and the invitation to the public to duplicate them endlessly. (map C3)

PEMBERTON STREET PARKS

With the Rindge Field, Anderson Courts, McMath Park, Bergin Park and Peabody School, this area of North Cambridge contains something for every open-space interest — from the community gardens in McMath Park, to the heavily used tennis and basketball courts, to the “rain-clouds” waterplay and landscaped pedestrian bridge at Bergin Park. The just opened Yerxa Underpass connects all of this open space to the neighborhoods just across the commuter rail tracks. (map no. 4, 5, 50, 57–C2)

CLARENDON AVENUE PLAYGROUND

Completed with city funds dedicated through the North Cambridge Stabilization Committee, this park serves the outer North Cambridge area with a playground and hard surface play and sitting area. (map no. 9–B1)

RUSSELL FIELD

The recent renovations to Russell Field include the City's first official football fieldhouse, constructed in “green” fashion to be as thoughtful about energy and material use as it is about supporting the many soccer and football playing students who use the facility throughout the school year. The artificial turf football/soccer field is state-of-the-art, providing a safe, dry playing surface in all weather conditions. Also included in the renovations are a new tot-lot and renovated ballfields for Cambridge Little League. (map no. 59–B2)



TOBIN FIELD, FATHER CALLANAN PLAYGROUND

Renovations are underway at this school playground/neighborhood park between Vassal Lane and Concord Ave. There will be new play areas close to the school, new waterplay in both the tot-lot and older children's playground. Also included are new pathways and lighting, which will connect the neighborhoods on either side of this new park to both the park and to each other. (map no. 20, 66–C3)

CORPORAL BURNS PARK

Recent renovations included new play equipment and waterplay, as well as a new promenade along Flagg Street down to the river. Images based on plants and animals of the nearby riverbank are located on the opposed sides of eight bollards at park entrances and on four granite panels that are placed in the ground of the promenade. (map no. 13–F4)



PARKS AND PLAYGROUNDS 2007
RIDE INFO: www.cambridgebikes.org



KING SCHOOL PLAYGROUND

As do many school parks in Cambridge, this park functions as a school playground and a neighborhood park — thus the inclusion of waterplay (not for school time!). There are evocative images for play, as well as innovative slides and spinning devices. The green field play area is one of a number of artificial turf locations in Cambridge. (map no. 90–F4)

FRANKLIN STREET PARK

Franklin Street Park is a small “urban oasis” the size of a house lot, tucked in a residential neighborhood between Harvard Square and Central Square. For years it was a dark, sunken, tree-filled area defined by concrete surfaces and angles. Few people used it. In 2003 it was transformed by major changes in landscaping and the public art of artist Murray Dewart, to a much used sitting area, with waterplay and a “dome” for toddlers to play. (map no. 23–F3)



Sunday,
September 30

10:15 a.m. Start
Cambridge Common

PARKS
and
PLAYGROUNDS



Sunday, September 30
10:15 a.m. Start
Cambridge Common

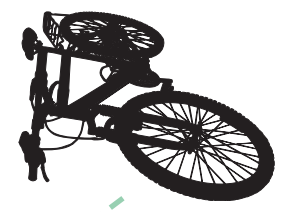

start: 10:15^{AM} arrival at Cambridge Common
10:30^{AM} ride starts
refreshments: Gold Star Mothers Park
ends: Cambridge Common
ride length: 13.5 miles
ride time: approx. 2.5 hours



DANA PARK
Recent renovations to this well-used park included new waterplay fountains, play equipment, basketball hoops, and a number of new sitting/picnic/gathering areas — places for family reunions and birthday parties. (map no. 15–G4)

UNIVERSITY COMMON
This privately owned but publicly accessible open space is part of the University Park development. Grouped into four plazas, nearly 50 two- and three-dimensional pieces trace the area's history, including a refractor telescope that celebrates groundbreaking local innovations; a mist fountain and bronze oyster shells that represent Cambridgeport's estuarine past; and a giant spool that recalls the cable company that occupied the site circa 1895. (map G4)



SQUIRREL BRAND PARK
With the closing of this historic candy business in Cambridge, the City and the Area IV Coalition combined resources to preserve the open space as community gardens, and turn the building into affordable housing. (map no. 63–G3)

Acknowledgments Thanks to city staff and members of the Cambridge Bike Committee for their work in making this ride possible. In particular, thanks to Stuart Dash, Brendan Monroe and Stephanie Andenberg of the Community Development Department; Katie Macy and Lilian Hsu of the Cambridge Arts Council; Sgt. Kathy Murphy and the Cambridge Police Bike Patrol officers; Jenni Alden, Katie Anthony, Tim Ledlie, Steve Miller, Ginna Smith, and Gerry Swislow of the Bike Committee. Thanks to Macky Buck for speaking at the Clarendon Avenue Playground. Also thanks to Whole Foods Market on River Street for their support.

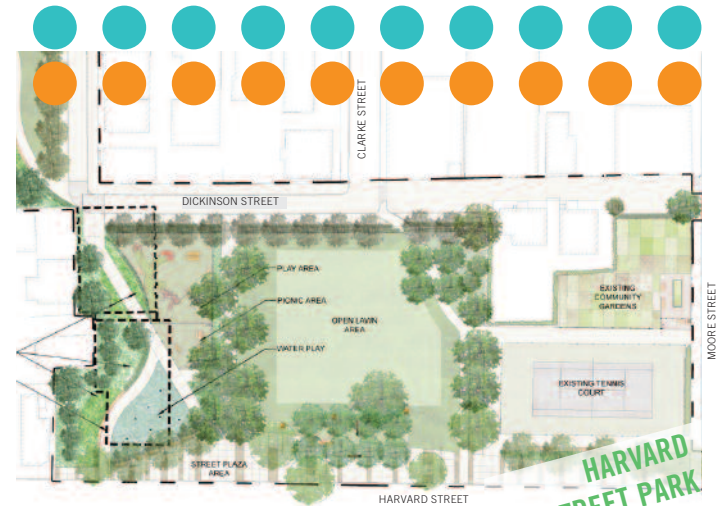

HARVARD STREET PARK
With the recommendation of the Green Ribbon Report for the acquisition of new open space in this area, the city took the initiative to purchase the parcels and buildings abutting the original Harvard Street Park, increasing the open fields space and play area available in this densely populated area. (map no. 33–G3)

GOLD STAR MOTHERS PARK
Major construction activities on Gold Star Mothers Park were completed in August 2006, and include renovated waterplay, innovated play structures, and improved pathways and lighting throughout the park. (map no. 31–H2)



end